

Baby Diaper BD-06

Main Technical Data

Production Speed (max)	600 pcs/min
Linear Web Speed (max)	300 m/min
Product Length (min-max)	360-570 mm
Pad Width (max)	120 mm
Product Width (min-max)	250-360 mm
Chassis Width (min-max)	210-240 mm
Fold Type	Bi-Fold
Typical Overall Dimensions (LxWxH)	30x10x6.3 m
(All features w/o Filter)	
Power Installed	500-750 KW
Power Consumption	280-420 KW

Machine Concept

BD06 Is available in classical model and 4 different Side Panel Configurations:

- 1- Symmetrical Zero Waste Back Panels with Tape
- 2- Symmetrical Zero Waste Back Panels with Hook
- 3- Asymmetrical Low Waste Back Panels with Tape
- 4- Asymmetrical Standard Waste Back Panels with Tape

Machine Features

- Full Servo Technology
- Electronic Job Change
- High quality multi-zone forming system with 2D/3D core design
- SAP/fluff ratio up to 65/35
- Core wrapping with C Folding configuration
- Stand alone unwinders
- Automatic splicing units "ZERO SPEED"
- Tension control via load cells and dancer rolls
- Automatic web guiding systems
- Full feature product (ADL, Back Sheet Lamination, 3-pieces product, elastics cutting and waist sealing)

Optional Machine Features

- Thermo bonding for cuffs elastic lap sealing
- Thermo bonding for cuffs sealing
- Ultra-sonic for cuffs sealing
- Back Sheet Online Lamination, Front Ear and Frontal Tape
- Wetness Indicator on Back Sheet
- Channels on Pad
- Lotion Application on Top Sheet
- Visual Web Inspection system with multi cameras including single ejection feature



Standard Asymmetric Shaped Ears

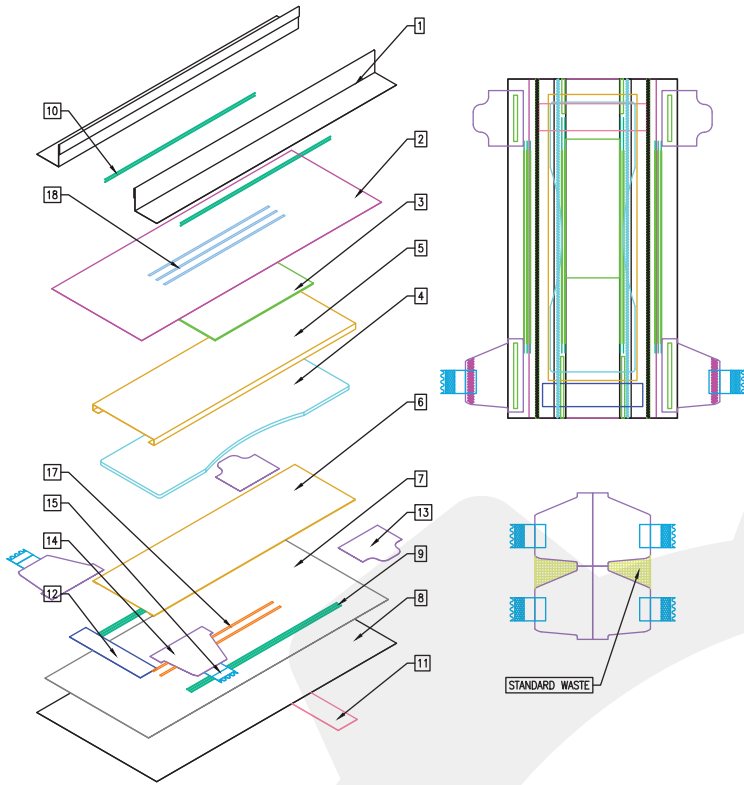

Low Trim Asymmetric Shaped Ears

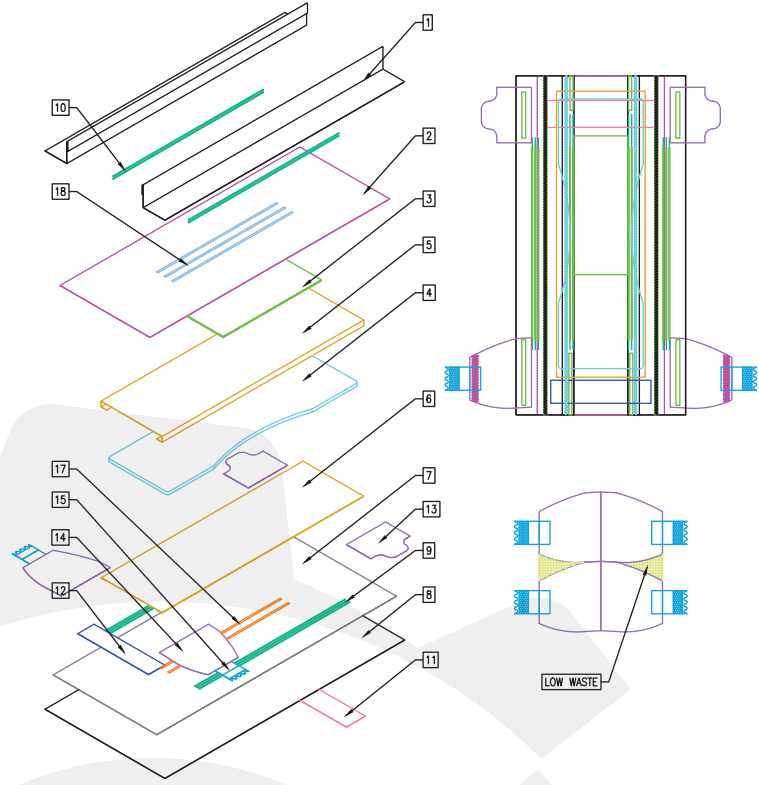

No Trim Symmetric Shaped Ears with Tape

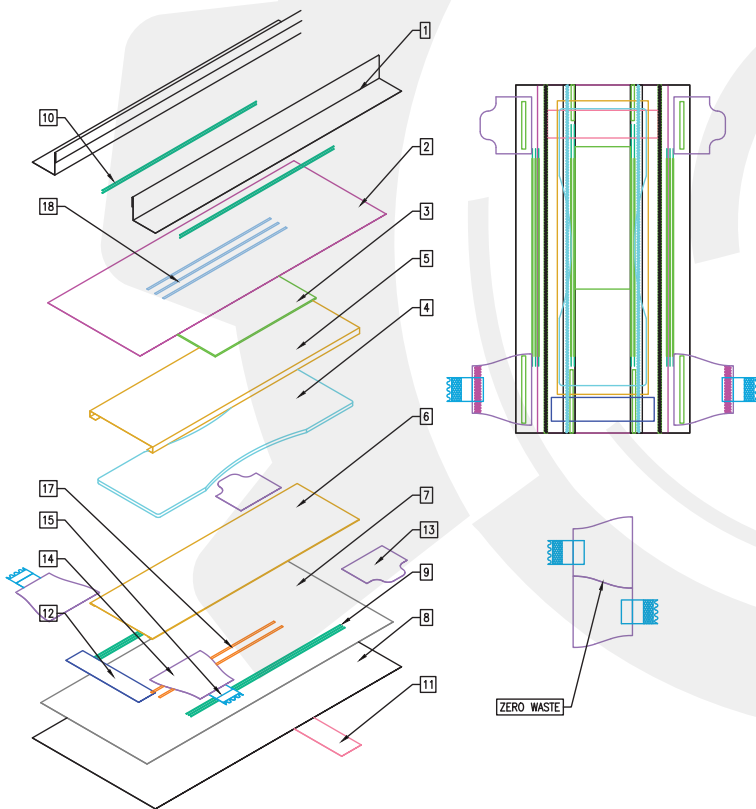

No Trim Symmetric Shaped Ears with Hook

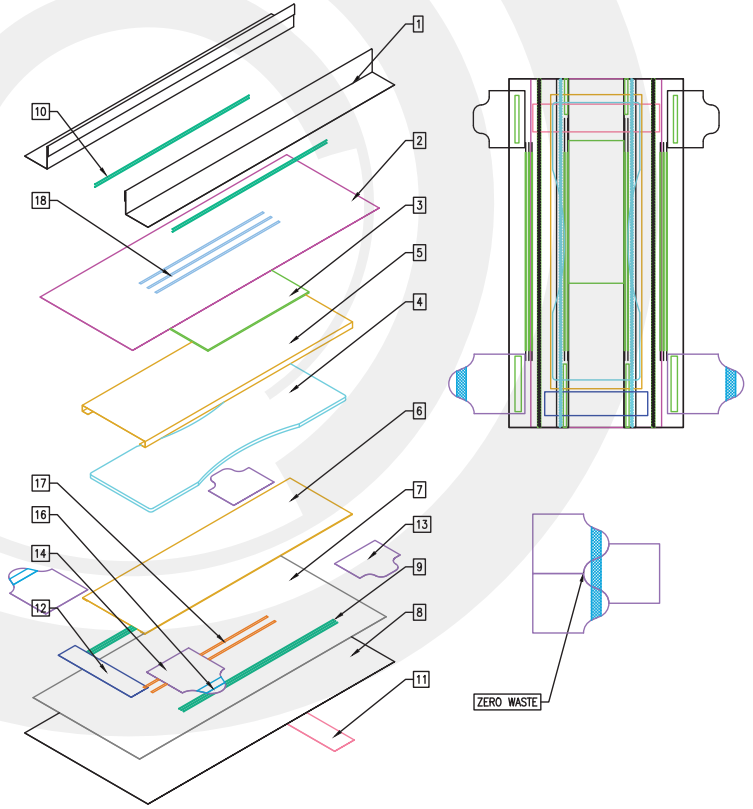

Material Specification:

1 CUFFS NONWOVEN	7 PE BACK SHEET	13 FRONT SIDE PANELS
2 TOP SHEET NONWOVEN	8 NW BACK SHEET	14 BACK SIDE PANELS
3 DISTRIBUTION LAYER	9 LEG ELASTICS	15 FASTENING TAPES
4 FLUFF PAD + SAP	10 CUFFS ELASTICS	16 FASTENING HOOKS
5 UPPER CORE COVER	11 FRONTAL TAPE	17 WETNESS INDICATOR
6 LOWER CORE COVER	12 ELASTICS WAIST BAND	18 LOTION ON TS

For Inquiries & Quotations